

DIMENSION TABLE

SIZE	1/2
L	56±1mm
A	1/2"NPT
B	1/2"NPT
C	54±1.5
D	13.5±1
E	2.2±0.5
S	25±0.5

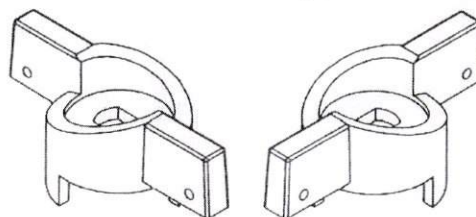
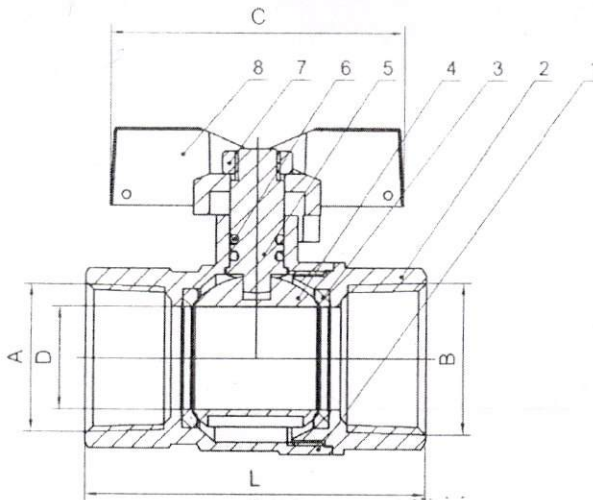
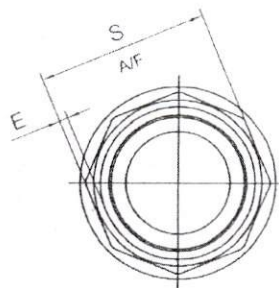

Technical requirements:

1. Before assembling, all parts should be clean, no burrs, no flash;
2. Bonnet should be coated with sealant before assembling;
3. handle should be open and closed freely;
4. Wide open ball valve, the through hole axis angle between valve body and ball not larger than 3°;
5. The closure testing should be carried out at least testing pressure not less than 0.6Mpa by air.
6. Manufacturing specification as per EN331;
7. Threading as per ASME B1.20.1.

NO.	Item Name	QTY	Material		
1	Body	1	Brass	TECHNICAL SPECIFICATIONS	
2	Bonnet	1	Brass	MEDIUM	NATURAL GAS
3	Gasket	2	PTFE	END CONNECTION	1/2",NPT(F) at both inlet and Outlet
4	Ball	1	Brass	OPERATING PRESSURE	4bar(g)
5	Stem	1	Brass	OPERATING TEMPERATURE	0°C TO 45°C
6	O-Ring	2	NBR	DESIGN PRESSURE	6bar(g)
7	SCREW/NUT	1	STEEL	DESIGN TEMPERATURE	0°C TO 65°C
8	Handle	1	AL	OPERATOR	BUTTERFLY HANDLE
				MATERIAL OF CONSTRUCTION	BODY&BONNET&BALL & STEM FORGED BRASS

TOTAL:

ISOLATION BALL VALVE
1/2" NPT A6101

DW NO. :

10.61151.N15.CP0Q-2922

FACTORY STAMP

For Tender
Purpose Only

IMPORTER STAMP

CUSTOMER STAMP

DIMENSION TABLE

SIZE	1/4
L	60±1mm
L1	23.5±1
L2	10±1
A	1 / 4 NPT
B	8±1
C	5±1
D	10±1
E	50±5
F	1.6±0.5
S	18±0.5

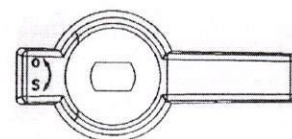
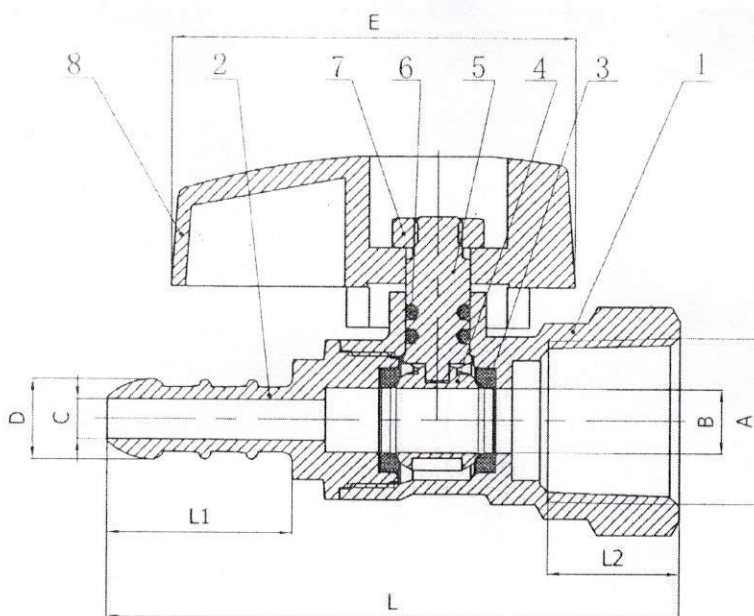
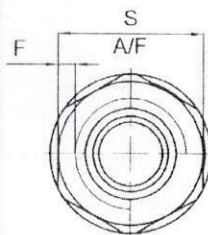

Technical requirements:

1. Before assembling, all parts should be clean, no burrs, no flash;
2. Bonnet should be coated with sealant before assembling;
3. handle should be open and closed freely;
4. Wide open ball valve, the through hole axis angle between valve body and ball not larger than 3°;
5. The closure testing should be carried out at least testing pressure not less than 0.6Mpa by air;
6. Manufacturing specification as per EN331;
7. Thread as per ASME B1.20.1.

NO.	Item Name	QTY	Material	TECHNICAL SPECIFICATIONS	
1	Body	1	Brass	MEDIUM	NATURAL GAS
2	Bonnet	1	Brass	END CONNECTION	1/4"NPT (F) at both inlet and Outlet
3	Gasket	2	PTFE	OPERATING PRESSURE	35 mbar (g)
4	Ball	1	Brass	OPERATING TEMPERATURE	0°C TO 60°C
5	Stem	1	Brass	OPERATOR	Knob Type Handle
6	O-Ring	2	Rubber	MATERIAL OF CONSTRUCTION	BODY /BONNET/ BALL : FORGED BRASS
7	SCREW/NUT	1	STEEL		
8	Handle	1	AL		

DESCRIPTION:

APPLIANCE BALL VALVE
1/4" NPT MODEL NO.: A6313

DW NO.:

10.63151.N08.CP02-2920

For tender
purpose only